

**Riverstone HOA**  
***Dock Details***

**Design** – The design of all docks on Lake Riverstone is to be very simple and straight forward. Docks should not be an architectural statement that will take anything away from the architecture of the homes that are located on the lake. All docks shall have the same simple design with a flat deck and finished sides. A simple bench type of seat without a back may be added. Railing will not be permitted. All decking material and exposed sides must be constructed with TREX decking material and must be grey in color.

**Construction** - Because Lake Riverstone has a sealer on the bottom of the lake it is important that the bottom of the lake not be compromised by having posts driven through the sealer. Additionally since it is a detention lake and the water level can rise several feet above the bulkhead the construction must be such that would allow for the dock to be temporarily submerged below the water and not float to the surface. Because of these conditions all construction of any dock must be controlled by the HOA. With that said all dock construction will be done by the official Riverstone Dock Builder listed below. This contractor has done many docks in lake oriented communities such as Avalon and others. Please contact John Carrier for a quote and a proposal.

Carrier Carpentry  
John Carrier's Office (281) 371-2150  
John Carrier's Cell (281) 433-6398

P:\Riverstone\EXHIBITS\Boat-Dock\Dock\_Const.dgn  
5/19/2010 2:04:49 PM

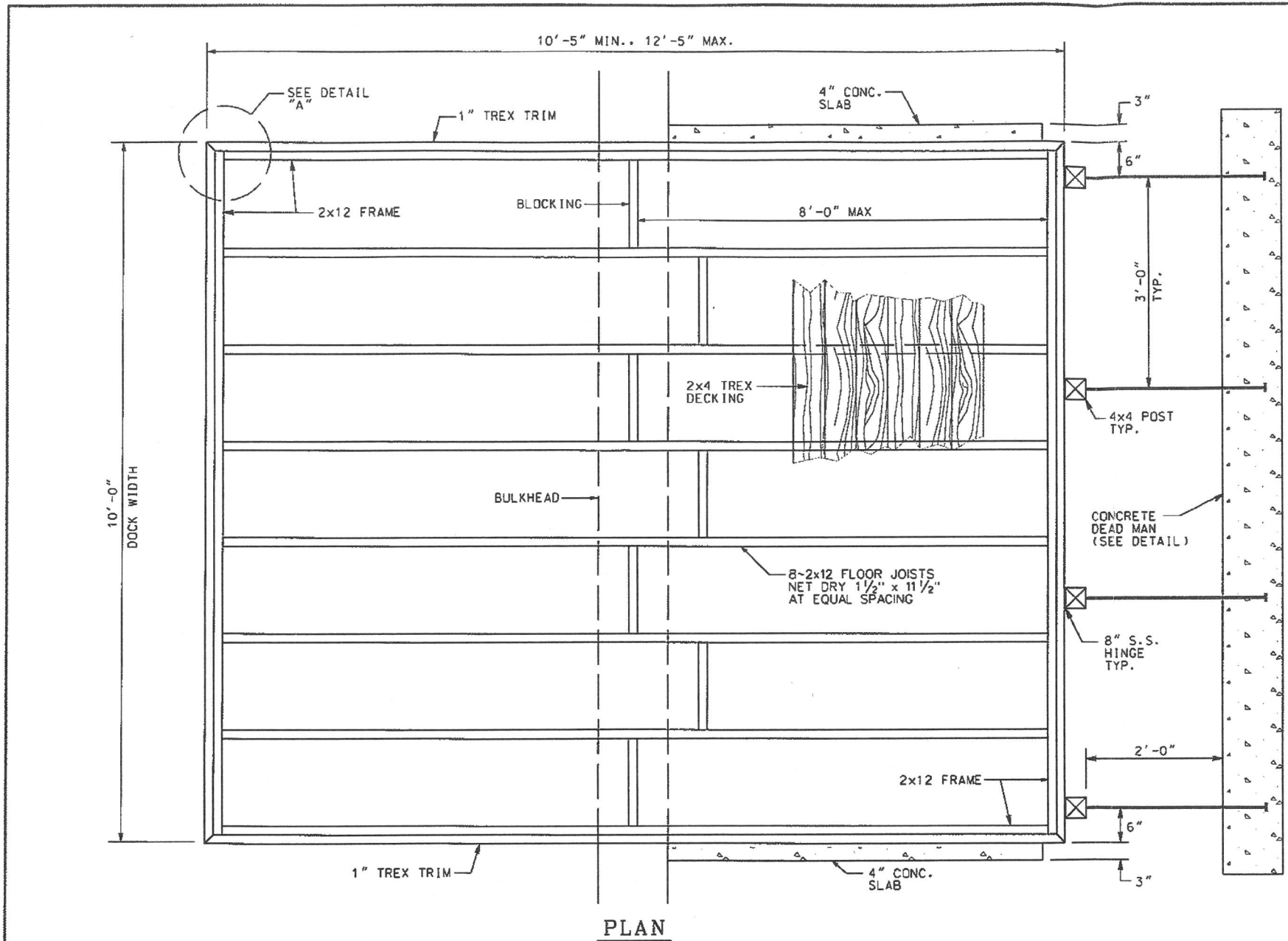

PLAN

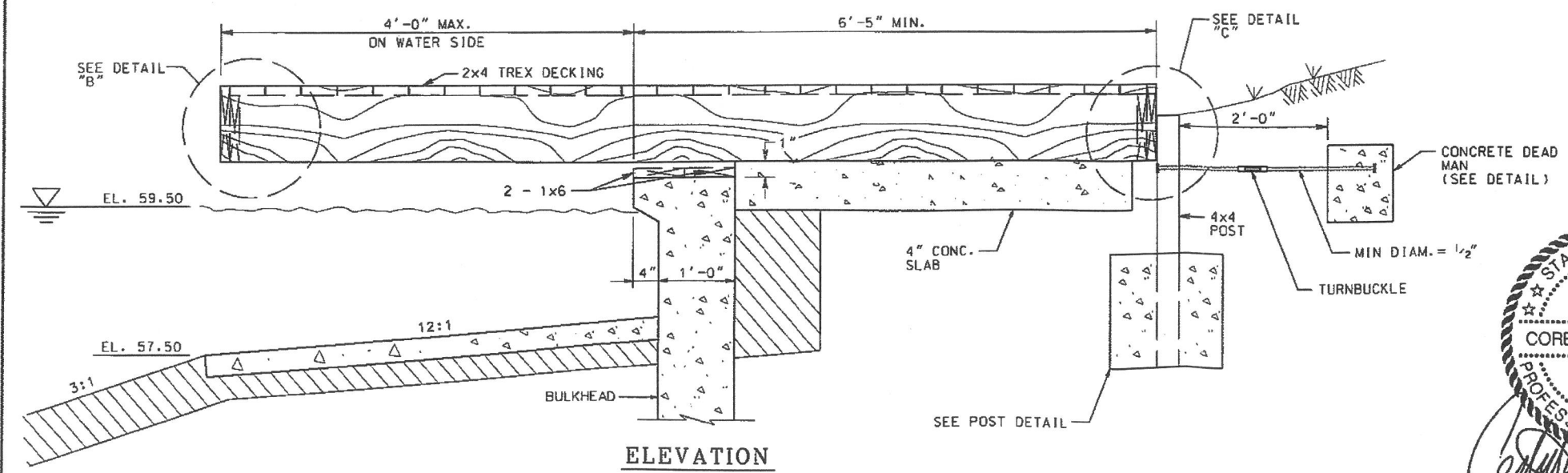

ELEVATION

GENERAL NOTES:

1. THIS EXHIBIT ILLUSTRATES THE MINIMUM STANDARD FOR DOCK CONSTRUCTION.
2. ALL DECK & TRIM MATERIALS SHALL BE TREX DECKING OR EQUAL. ALL STRUCTURAL TIMBERS SHALL BE GRADE NO. 1 OR BETTER TREATED LUMBER.
3. CONCRETE SHALL BE CLASS "C" WITH 1'C OF 3,000 PSI.
4. FLOOR JOISTS SHALL VARY LESS THAN 1/8". IF CROWNING IS PRESENT, JOISTS SHALL BE INSTALLED WITH THE PEAK OF THE CROWN UP.
5. HANGERS AND FASTENERS SHALL BE CHOSEN TO MEET OR EXCEED THE CAPACITY OF THE TIMBER MEMBERS. FASTENERS SHALL BE CHOSEN ASSUMING THAT ALL TIMBER WILL BE CONSIDERED WET AT TIME OF CONSTRUCTION DUE TO PRESSURE TREATING.
6. NET DRY DIMENSIONS ARE 1/2" LESS THAN NOMINAL UNLESS OTHERWISE NOTED.
7. FOR DOCK WIDTHS GREATER THAN 10 FEET, THE SAME PATTERN OF SUPPORT SHALL BE UTILIZED WHICH INCLUDES THE SPACING AND SIZES OF JOISTS, POSTS, ETC.
8. OWNER IS RESPONSIBLE FOR INSPECTION AND MAINTENANCE OF SLOPE AND HINGE SYSTEM.
9. CONTRACTOR SHALL VERIFY THAT INSTALLED HINGES CAN MOVE FREELY WITHOUT BINDING.

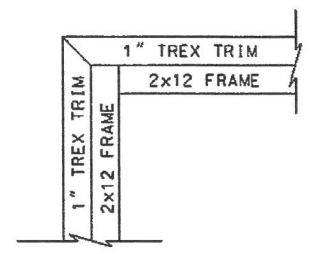

DETAIL "A"  
N.T.S.

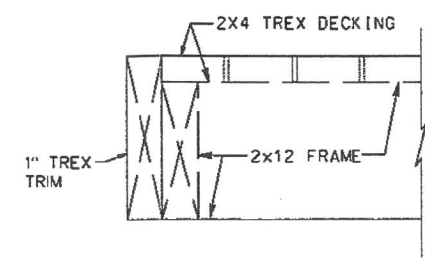

DETAIL "B"  
N.T.S.

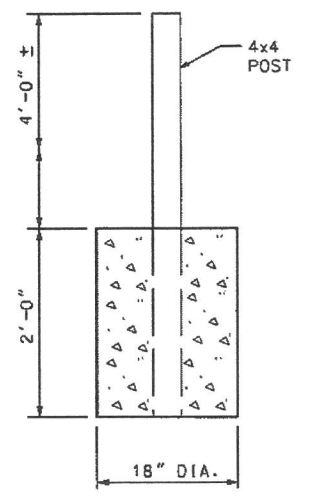

POST DETAIL  
N.T.S.

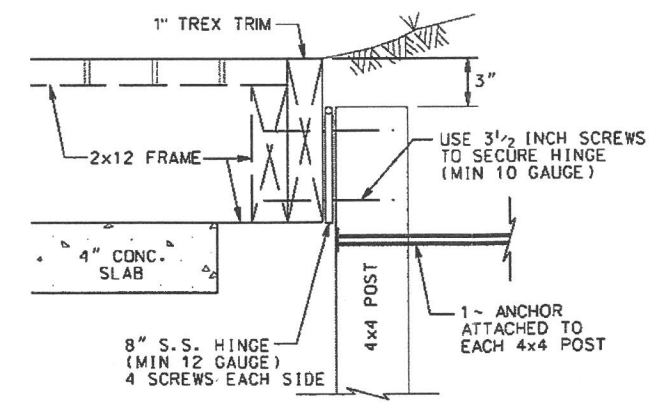

DETAIL "C"  
N.T.S.

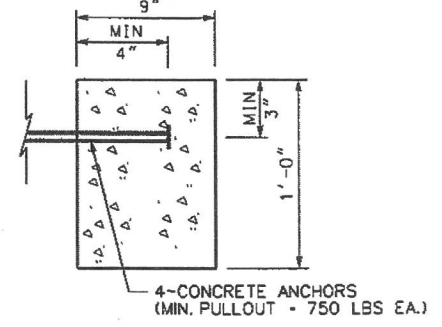

CONCRETE DEAD MAN DETAIL  
N.T.S.

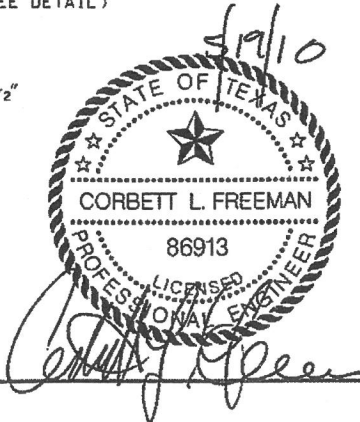

Engineering and Surveying  
9990 Richmond Avenue, Suite 450  
North Building  
Houston, Texas 77042  
(713) 783-7788 (713) 783-3580, Fax  
TEXAS PE BOARD FIRM  
REGISTRATION No. 280

DOCK CONSTRUCTION EXHIBIT

JOB NO.: 2005099 - SR2 DATE: MAY 2010 EXHIBIT NO.: 1

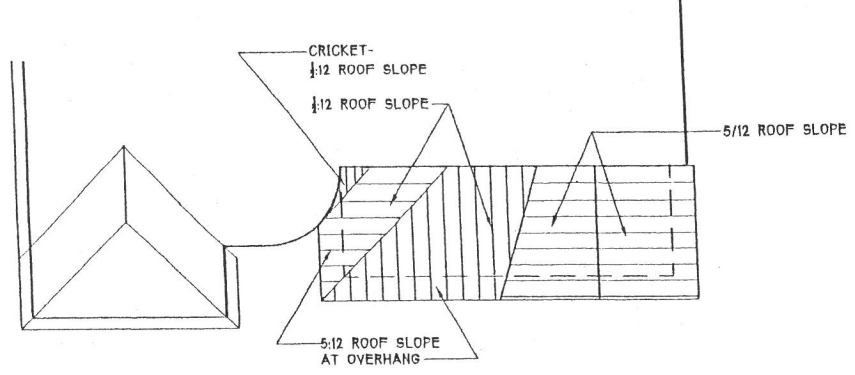

ROOF PLAN 1/8"  
RAFTERS: 2X6-16" O.C.

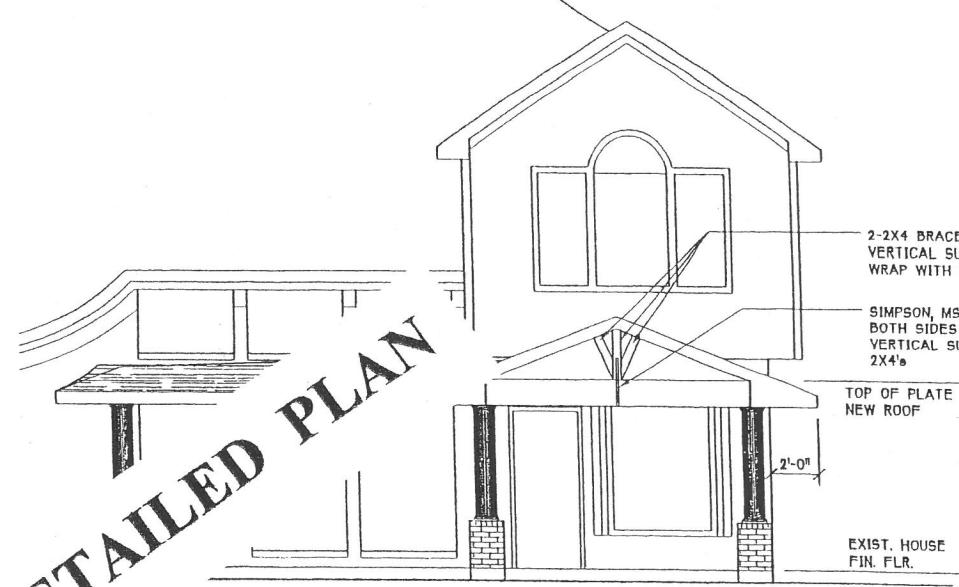

REAR ELEVATION 1/4"

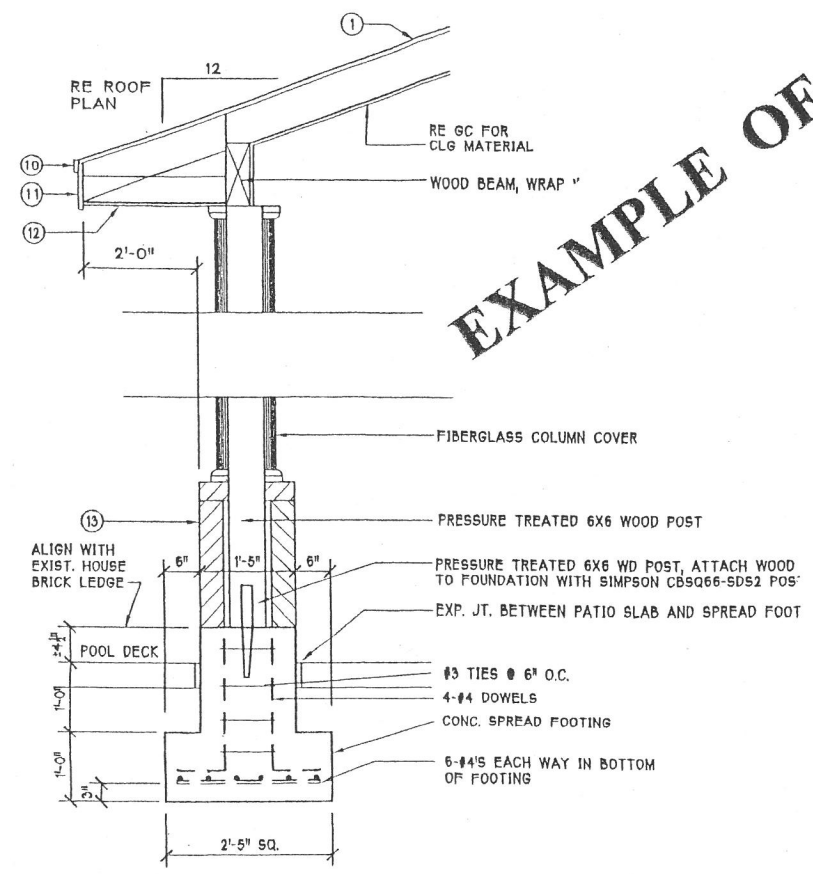

2 SECTION DETAIL 3/4"

EXAMPLE OF A DETAILED PLAN

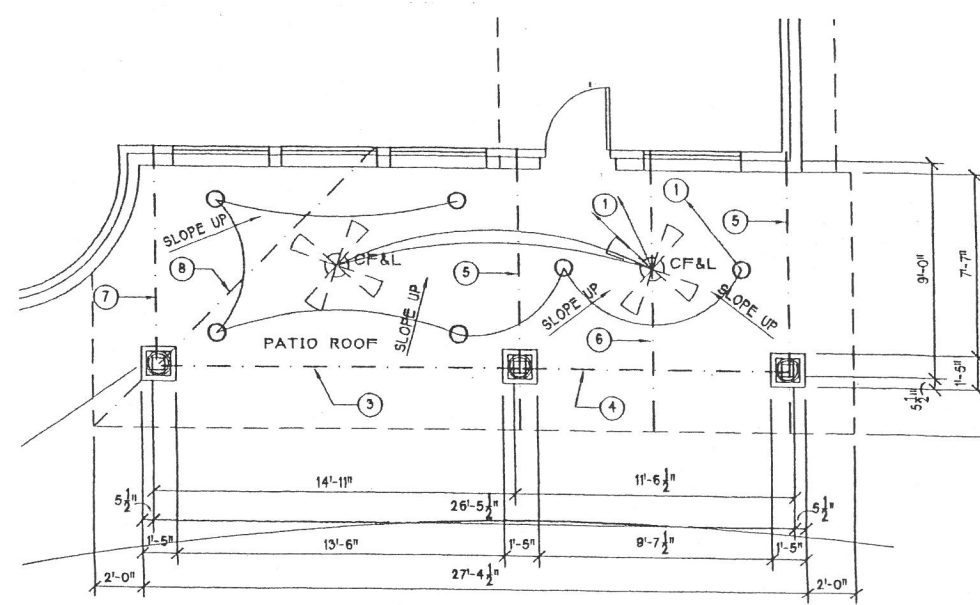

← NORTH

ARCHITECTURAL 1ST FLOOR PLAN 1/4"

XXXXXXXXX INDICATES NEW WALLS (NOT AN INDICATION OF INSULATION)